

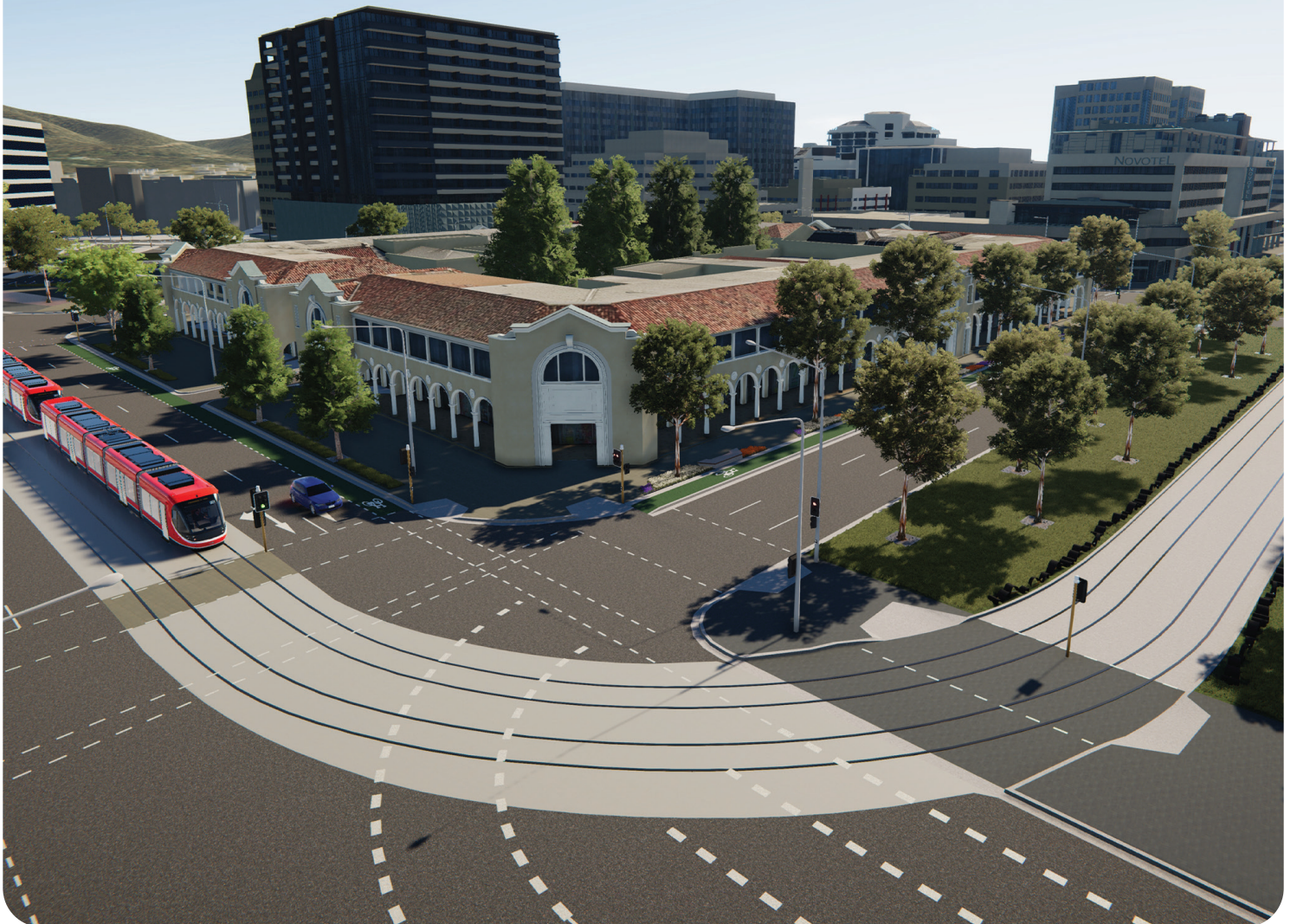

# LABOR'S PLAN FOR THE INNER NORTH





ACT Labor has been working hard to deliver more services and infrastructure in the Inner North. We have expanded services across our network of Walk-in Centres, opened new playgrounds and made improvements to local schools.

From paths and playgrounds to housing and health services, ACT Labor has a plan to build the infrastructure the Inner North needs and improve the things locals love.



# OUR PLAN FOR THE INNER NORTH



## HEALTH

A re-elected Labor Government will build a new Northside Hospital on the existing North Canberra Hospital campus. We'll invest more than \$1 billion to build a state-of-the-art hospital with a bigger emergency department and more treatment spaces.

We're expanding services and hiring more nurses at the Inner North Walk-in Centre so locals can access free healthcare, closer to home.



## TRANSPORT

It was ACT Labor that built light rail for Canberra, providing a reliable public transport network from Gungahlin to the city through the Inner North.

We will continue extending the light rail network, starting with the city to Commonwealth Park extension.

We will increase the frequency of bus services to every 20 minutes on a weekday, across all local bus routes in the Inner North. We will also improve the frequency of weekend services on local routes, with hourly buses on Sundays.



## SCHOOLS

We're working with the community to upgrade schools including Majura Primary, Lyneham High, Campbell Primary and

Campbell High School, O'Connor Cooperative School and Turner School.



# OUR PLAN FOR THE INNER NORTH



## COMMUNITY

We'll build a new Canberra Theatre Precinct with a new 2000 seat lyric theatre. This will attract international acts and visitors to Canberra

To support local arts and community groups, we're also upgrading Gorman Arts Centre.

To support local sports, we will upgrade change rooms in Ainslie, O'Connor and at Reid Oval to make them female friendly.

We're building a new emergency services station in Acton to improve response times in the Inner North. We'll also continue to work with ACT Police on a new, modern City police station.



## SPORTS

We will upgrade the change rooms at Griffith and Narrabundah playing fields to make them female friendly, supporting local sports groups and participation.

We will also continue improvements at Manuka Oval to attract international sports games to Canberra.



## PARKS & PLAYGROUNDS

We have recently completed a major new park and playground on Aspinall Street in North Watson.

Construction has also begun on a new destination playground for the Inner North on Windeyer Street, providing families with new play equipment, toilets, a BBQ area and new sports facilities.

We are building a new, lively precinct at Acton Waterfront, with a new playground being added to the recently completed boardwalk.

A re-elected Labor Government will work with the National Capital Authority to remove Monash Drive (running behind Hackett, Ainslie and Braddon) from the National Capital Plan to ensure this area is protected from future road construction.



# OUR PLAN FOR THE INNER NORTH



## PATHS AND ROADS

The first stage of the Garden City Cycleway is under construction, providing a safer and improved cycling network through the Inner North. A re-elected Labor Government will deliver the next stages of the cycleway to Dickson, Downer and Watson.

A re-elected ACT Labor Government will invest in new and improved footpaths in the Inner North.

This will be in addition to work already underway to upgrade and improve footpaths in Braddon, O'Connor, Reid and the City.

We are delivering raised crossings on Bauhinia Drive in O'Connor to improve pedestrian safety and strengthen this key cycle route.

A re-elected ACT Labor Government will also build a raised crossing on Challis Street in Dickson.

Upgrades to Beltana Road in Pialligo are close to completion, which will support local businesses and improve traffic conditions for residents and visitors.



## SHOPS

We'll continue upgrades to Braddon, Garema Place and Dickson Shops to support local businesses.

A re-elected Labor Government will build a new public toilet at Downer Shops.

We will keep working to revitalise the Sydney and Melbourne Buildings and complete upgrades to Odgers and Verity Lanes.



## HOUSING

As part of ACT Labor's Housing Plan, we'll work to deliver more houses closer to local shops. This will provide more housing choice and help to rejuvenate local shops and suburbs.

We are also supporting a new build-to-rent development in Turner.



**PROGRESSIVE  
PRACTICAL  
PROVEN**

Authorised by Ash van Dijk for ACT Labor